

Air-Starting Systems

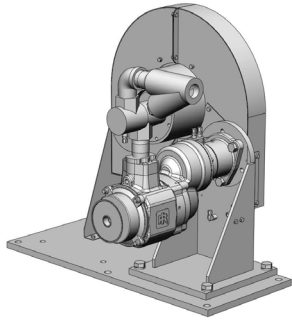

63193 Air-Starting System shown

Overview

The Power Test Air-Starting System is mounted to the dynamometer and provides the cranking torque needed to start an engine connected to the dynamometer.

Air-Starting Systems:

- Eliminate the storage batteries, cables, and charger required by a conventional electric starter.
- Are powerful enough to quickly start the engine at the touch of a button utilizing the through-shaft design of the Power Test dynamometer.
- Commonly available in two sizes for engines above and below 900ci.
- Are available in both CCW and CW rotation configurations.
- Tandem air starting systems for increased torque are available on request.

The Power Test Air-Starting System includes a dynamometer-mounted companion flange with flywheel ring gear and guard. When configured with the dual air starter option, engaging the proper starter will start engines of either rotation.

Description	Part #	Peak Breakaway Torque** (ft-lbs)	RPM @ Max Power*	Peak HP @ 90 psi	Flow @ Max Power (SCFM)	Weight (lbs)
Single Air Starting System - PTX	63301.01	714	270	18	365	210
Dual Air Starting System - PTX	63568	714	270	18	365	315
Single Air Starting System - 35/50X	63182.01	714	270	18	365	422
Single Air Starting System - 35/50X	63159.01	2,635	265	66	1,700	440
Dual Air Starting System - 35/50X	63183	2,635	265	66	1,700	545
Single Air Starting System - 45X	63193.01	3,060	228	66	1,700	424
Dual Air Starting System - 45X	63223	3,060	228	66	1,700	675
Single Air Starting System - H36	73268	7,650	91	66	1,700	1,140
Dual Air Starting System - H36	1001825	7,650	91	66	1,700	1,570

* Speed and torque ratings listed are rated at the crankshaft.

** Tandem air starting systems to increase torque ratings are available on request.



N60 W22700 Silver Spring Drive • Sussex, WI 53089 USA
 phone: (262) 252-4301 • fax: (262) 246-0436
www.powertestdyno.com