

Water Brake Engine Dynamometer - PT-3600

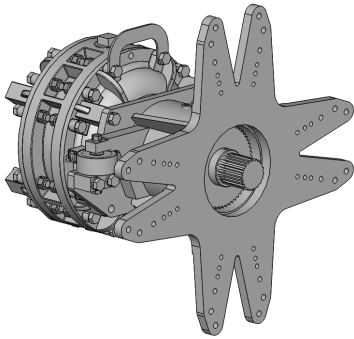

PT-3600 Portable Engine Dynamometer Shown

Overview

Power Test PT-3600 Portable Water Brake Dynamometer is specifically designed for testing small to medium size diesel engines.

The PT-3600 Water Brake Engine Dynamometers feature:

- Power: up to 1,200 HP (895 kW)
- Torque: up to 3,600 Ft-lbs. (4,881 Nm)
- Speed: up to 4,000 RPM
- Uses positive water seals.
- Can be used in conjunction with Power Test DPM 300 series or PowerNet LT data acquisition systems.

The PT-3600 Portable Water Brake Engine Dynamometers may be used for continuous-duty engine power verification, quality assurance, endurance, and certification testing. Attachment to engine crankshaft or flywheel is application specific and will require engine specific adapters.

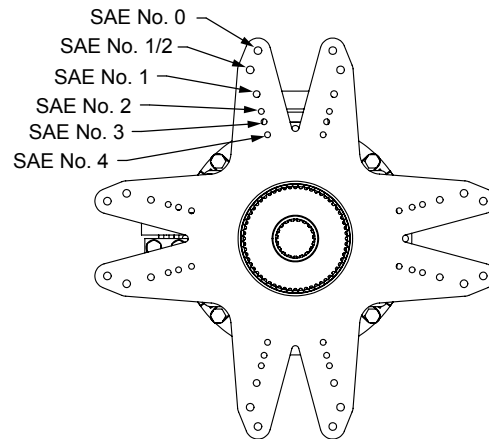
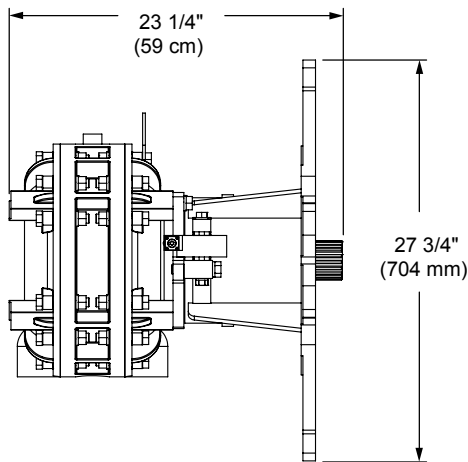

Accommodates SAE No. 0, 1/2, 1, 2
3 and 4 size flywheel housings.

***NOTE:** Dimensions shown are reference only, not actual.

Description	Part #	Weight Lbs. (Kg)
Portable Dyno Assembly	72106	550 (250)



N60 W22700 Silver Spring Drive • Sussex, WI 53089 USA
phone: (262) 252-4301 • fax: (262) 246-0436
www.pwrtst.com

Water Brake Engine Dynamometers - PT-3600

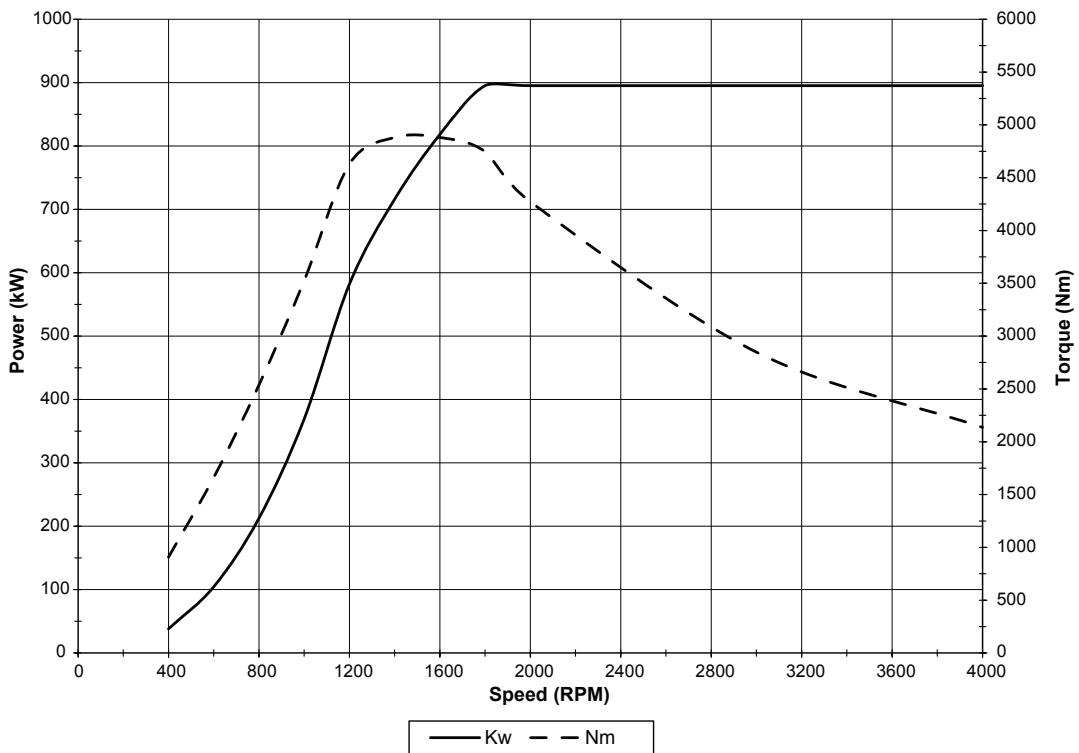
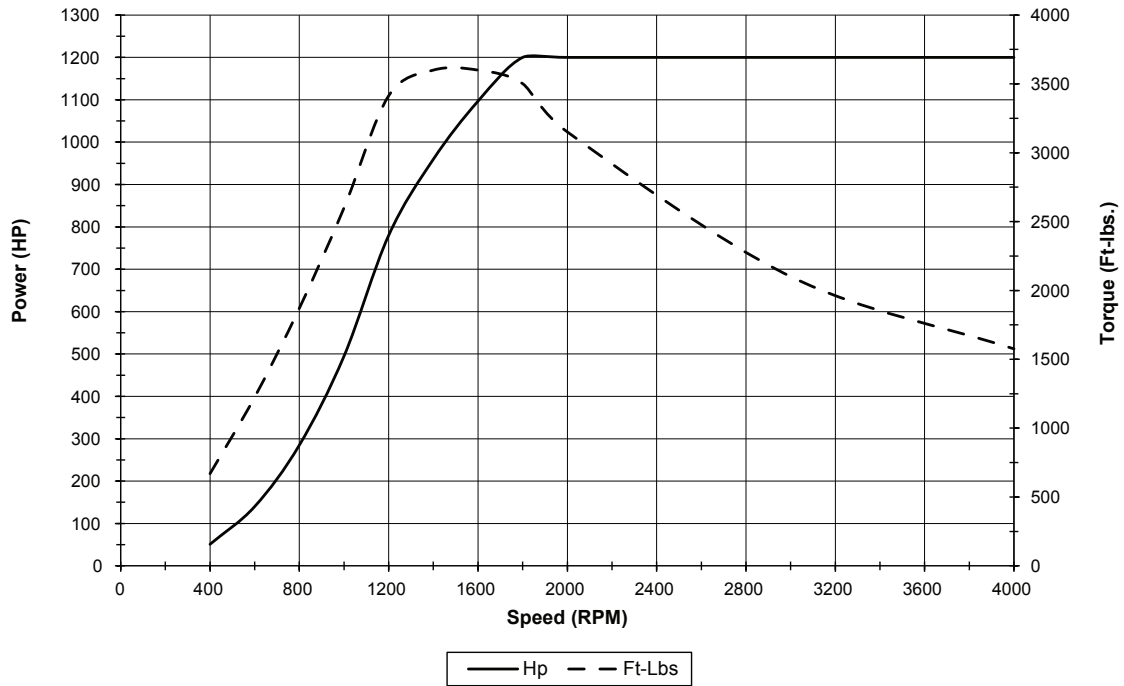

Power Test, Inc. manufactures a wide range of standard and custom water brake engine dynamometers. For absorption characteristics other than the model shown, please contact your Power Test representative.



N60 W22700 Silver Spring Drive • Sussex, WI 53089 USA
 phone: (262) 252-4301 • fax: (262) 246-0436
www.pwrst.com

Water Brake Engine Dynamometers - PT-3600

Mounting Configurations:

