

Engine Dynamometer Exhaust Hood System

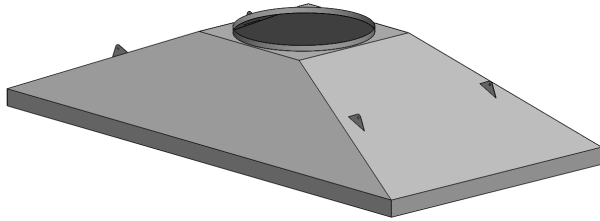

14237 16' x 8' Exhaust Hood shown

Overview

The Engine Dynamometer Exhaust System uses an exhaust fan to pull cool make-up air into the room as it evacuates hot air and exhaust gases from the room.

Room Exhaust System:

- Exhaust hoods made from 18 GA galvanized sheet metal with integrated hanger brackets.
- Variable Frequency Drive (VFD) motor controller with remote fan speed adjustment.
- Exhaust hood sizes vary per application.
- Customized system configuration may include, but is not limited to, the following options:
 - Adjustable Hood Height.
 - Stainless Steel.

Contact a Power Test representative for more information or to configure a room exhaust system for your application requirements.

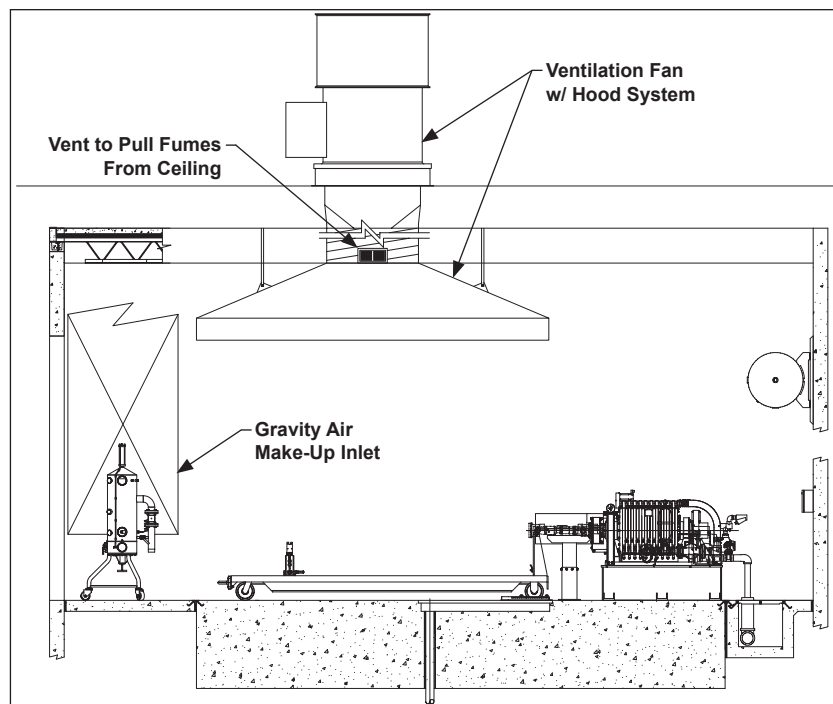

Hood Exhaust System shown



N60 W22700 Silver Spring Drive • Sussex, WI 53089 USA
phone: (262) 252-4301 • fax: (262) 246-0436
www.pwrtst.com