

PT-3600 Engine Dynamometer
www.pwrtst.com



PT-3600 ENGINE DYNAMOMETERS

The Power Test PT – 3600 Portable Water Brake Engine Dynamometer is specifically designed for testing small to medium size diesel engines. This portable design can be lifted and moved for attachment to engines in many locations. The body is made of robust cast-iron steel with a carbon steel shaft, and it has positive water seals.

The PT – 3600 will accommodate SAE No. 0, ½, 1, 2, 3, and 4 size flywheel housings for a wide range of testing capabilities. When combined with PowerNet, Power Test's fully automated dynamometer control system, all of your testing needs may be performed at the touch of a button.

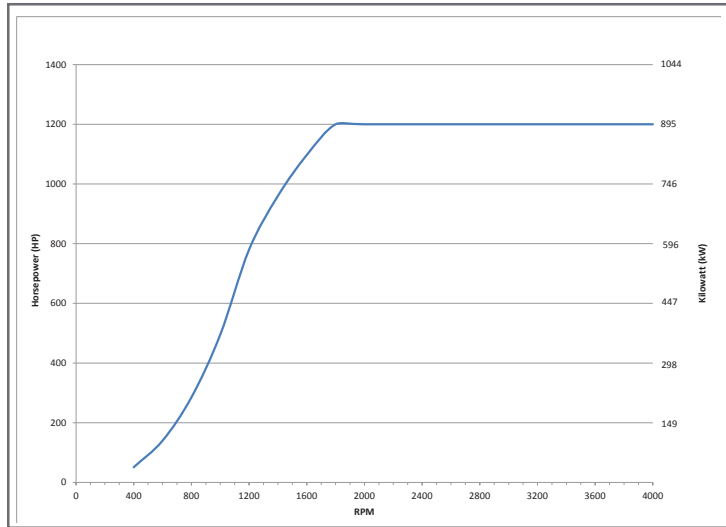
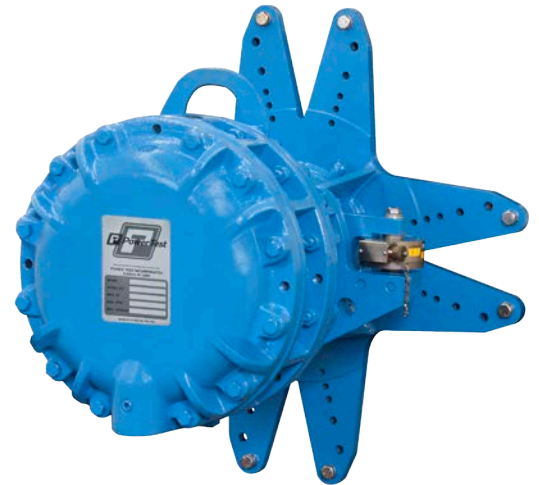

PT-3600

- For testing small to medium size diesel engines
- Power ranges from 15 H.P. to 1,200 H.P. (11 to 895 kW)
- Torque up to 3,600 Ft-lbs. (4,881 Nm)
- Speeds up to 4,000 RPM

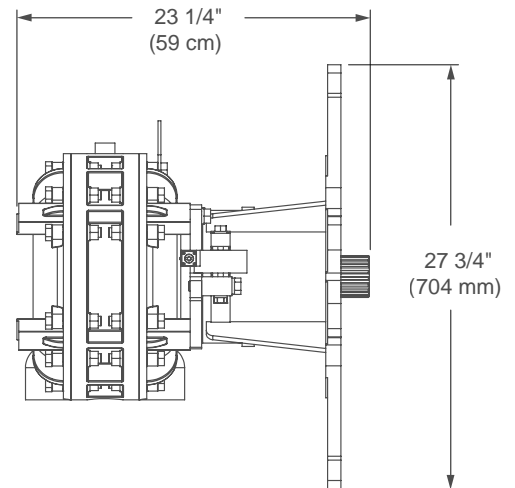

A Complete Testing Solution

Power Test provides a full range of test cell support equipment and accessories, including engine carts, air start systems, drive shafts, resilient couplings, engine adapters, water recirculation and cooling systems, fuel measurement systems, smoke opacity meters, additional temperature and pressure sensors, and analog input channels. Whether you are dealing with new installation or looking to repair, upgrade, or replace an existing dynamometer, Power Test has a solution.

Power Test, Your Full Service Dynamometer Manufacturer

Power Test can provide facility design and installation of every dynamometer we sell. We also offer a complete line of support equipment, including ventilation systems, exhaust systems, auxiliary cooling systems, and water recirculation systems.

Contact your Power Test representative or visit our web site at www.pwrtst.com for more information.

Power Test Incorporated
N60 W22700 Silver Spring Drive
Sussex, WI 53089 USA
262-252-4301
www.pwrtst.com